

The logo for the inMotion PPR Series, consisting of a red circle with 'in' in white, followed by the text 'PPR Series' in a bold, black, sans-serif font.

Push Pull Rods



The **inMotion** Push Pull Rods are handy, lightweight, flexible & STURDY! Use our Push-Pull Rods to get wire and cable into those “impossible” places quickly and easily! Ideal for pushing and pulling wire and cables in false ceilings, under floor channels, crawl spaces, attics and many other areas. Connect as many rods together to attain the length required.

These Push-Pull Rods will save you a lot of time and money. Tape your wire on to the leading rod and push it to the desired location by adding additional rods (they just screw into each other) or you can tape the wire to the rod (or hook it) and pull the wire to you from a distant location.

Each rod is made of aluminum alloy, 27” long and 3/4” O.D. and weighs only 5 oz. These rods are available in non-coated or coated sets which feature a 1000 V.D.C. dielectric strength coating, which is both tough and durable.

Each set comes with one curved handle pole and a bright yellow storage bag. Get a set today and make your installations go quicker and easier.

inMotion International Ltd

Asia

Europe

USA

	Model	PPR Series
Coating	Coated Rods-C	1000 V.D.C Dialectric Strength
Physical	Construction	Aluminum Alloy
	Dimensions	27" L x 3/4 OD
	Weight	5oz per rod
Ordering	inPPROD20-C	20 Coated Rods -45ft
	inPPROD10-C	10 Coated Rods - 22-1/2ft
	inPPROD5-C	5 Coated Rods -11-1/4ft
	inPPROD20-P	20 Non-Coated Rods - 45ft
	inPPROD10-P	10 Non-Coated Rods - 22-1/2ft
	inPPROD5-P	5 Non-Coated Rods - 11-1/4ft

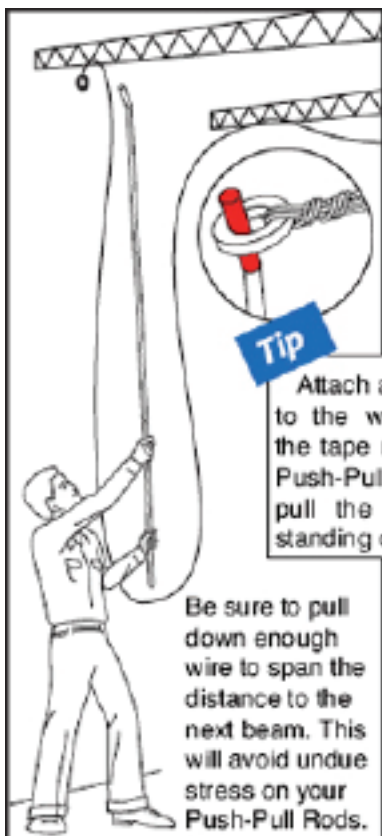

Tip

Attach a roll of tape to the wires. Catch the tape roll with the Push-Pull Rod and pull the wire while standing on the floor!

Be sure to pull down enough wire to span the distance to the next beam. This will avoid undue stress on your Push-Pull Rods.

Tip

When possible, join your rods ahead of time in groups of 3. This will make the job go a lot faster!



To push wire simply tape the wires to the end of the lead rod. Now push the wires to your desired location!



To pull wire simply make a hook from a wire clothes hanger and tape it to the end of the lead rod. Hook on to the wires and pull them wherever they need to go!

Why use ladders and scaffolding to pull wires over exposed beams? Do it quickly and easily from the floor!



Security installation! Push-Pull Rods are a real time saver when you need to pull those wires around the perimeter of a house or building!

inMotion International reserve the right to amend specifications and design without prior notice